

Rittal – The System.

Faster – better – everywhere.

Digital Brochure

ENCLOSURES

POWER DISTRIBUTION

CLIMATE CONTROL

IT INFRASTRUCTURE

SOFTWARE & SERVICES

FRIEDHELM LOH GROUP

www.rittal.ca



Rittal – The System.

Faster – better – everywhere.



System Accessories

Base/Plinth

Flex-Block Base/Plinth System	424
TS Base/Plinth	426
Base/Plinth	433

Base

Base	435
------------	-----

Walls

Sidewalls	450
Partition Walls	453
Interconnect Kit	458

Baying Systems

Baying	460
--------------	-----

Doors/Locks

Door Models	467
Expansion Accessories for TS Modular Front Design	469
Viewing Windows/Operating Panels	473
Lock Systems	478
Hinges	492
Door, External/Internal	493

Roof/Wall Mounting

Roof	499
Wall Mounting	503

Interior Fittings

Mounting Plates	507
Rail Systems	514
Assembly Components	533
Component Shelves	540
System Lights	545
EMC	551
Interior Fittings for Areas at Risk of Earthquake	554
Grounding	555

Cable Routing

Cable Entry	561
Flange Plates	564
Cable Gland	568
Cable Gland	569
Cable Management	572
Cable Routing 19"	582

19" Installation System

Pivoting Frame	587
Accessories for Data Rack	591
Profile Rails	592
Slide Rails	596
19" Fittings	598
Patch Panels	603
Splicing Boxes	604

Human/Machine Interface

Handles	605
External Mounting Accessories	607
Front Fittings	608
Keyboards, Supports and Drawers	610
Interfaces	617
Signal Pillars	619

Technical Information

RittalXpress	622
CE/Grounding/HD/Model Numbers	623
Protection Categories	624
NEMA	625
Approvals/Equipment Grounding Conductor	627
Coating/Spray Finish	628



Snap-On Nut TS

Metric thread for vertical TS, SE enclosure section. To mount, insert and clip into slotted holes. The snap-on nut is then secured in place. When the screw is tightened, it is securely braced against the profile, and equipotential bonding is automatically created.

Installation options:

- On the vertical TS, SE enclosure section and on the horizontal SE enclosure section (top, in the width)
 - With M6 or M8 metric thread
 - An alternative to sheet metal screws
 - Particularly well-suited for dynamically-loaded connections

Material:

- Precision-cast stainless steel

Accessories for interior fitting

- 1 Support rails, see page 529
- 2 Cable clamping rails, see page 574
- 3 C rails 30/15, see page 528
- 4 System support rails, see page 529
- 5 TS punched rail 25 x 38 mm, see page 524

Thread	Packs of	Model No.
M6	20 pc(s).	8800.806
M8	20 pc(s).	8800.808

! Also required:

- Multi-tooth screw M6 x 12 or M8 x 12, see page 539



Adapter Bracket TS

For mounting

- System lights
- Cable ducts

On the vertical TS enclosure section and on the horizontal SE enclosure section (top, in the width)

Material:

- Carbon steel

Surface finish:

- Zinc-plated

Supply includes:

- Assembly screws

Packs of	Model No.
6 pc(s).	8800.360



Interior Fittings

Assembly Components



Mounting Bracket TS

Offers variable mounting options for 23 x 23 mm punched rail, e.g. to support external surfaces or create an additional internal level.

Material:

– Die-cast zinc

Supply includes:

– 24 sheet metal screws 5.5 x 13 mm.

Packs of	Model No.
24 pc(s).	8800.370

+ Accessories:

– U nuts (recommended: M6), see page 538.

Installation options:

- On the vertical TS, SE enclosure section
 - flush with the outer edge of the enclosure or
 - flush with the enclosure clearance width



- 1** Support for the external surfaces with two mounting options:
- Without mounting plate (photo)
 - With mounting plate (drawing)

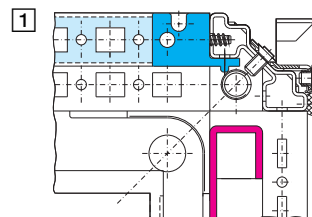

Two expansion options for the inner mounting level:

- 2** When no divider panel is mounted

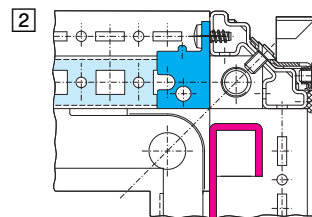

- 3** When a divider panel is mounted, with or without mounting plate in forward position

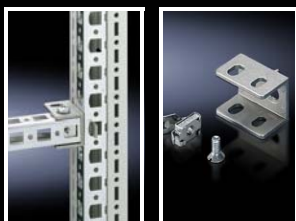
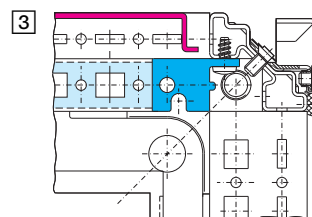

Mounting Bracket PS

For variable attachment of 23 x 23 mm punched rails.

Installation options:

- Optionally flush with
 - outer enclosure edge or
 - enclosure clearance width
- On the vertical TS, SE enclosure section using
 - Adapter rail for PS compatibility, see page 526
- On the horizontal TS enclosure section
- On the horizontal SE enclosure section, bottom
- On the horizontal SE enclosure section, top in the depth
- On enclosures and rails with rectangular hole profile 12.5 x 10.5 mm

Material:

– Die-cast zinc

Supply includes:

- 1 set =
 - 1 mounting bracket
 - 1 screw M6 x 12 mm,
 - 1 captive nut M6

Packs of	Model No.
24 set(s)	4182.000

! Also required:

- U nuts (recommended: M6), see page 538
- Multi-tooth screws M6 x 12 mm, see page 539

Angle Bracket PS

For quick attachment of 23 x 23 mm punched rails.

Installation options:

- On the vertical TS, SE enclosure section using
 - Adapter rail for PS compatibility, see page 526
- On the horizontal TS enclosure section
- On the horizontal SE enclosure section, bottom
- On the horizontal SE enclosure section, top in the depth
- On enclosures and rails with rectangular hole profile 12.5 x 10.5 mm

Material:

- Carbon steel

Surface finish:

- Zinc-plated

Supply includes:

- 1 set =
 - 1 angle bracket, left
 - 1 angle bracket, right
 - 2 sheet metal screws 5.5 x 13 mm

Packs of	Model No.
12 set(s)	4181.000



Also required:

- U nuts (recommended: M6), see page 538
- Multi-tooth screws M6 x 12 mm, see page 539



Support Bracket TS

For attaching:

- Punched section without mounting flange 23 x 73 mm, or
- Punched rails 23 x 23 mm

Installation options:

- On the vertical TS, SE enclosure section
 - in 25 mm hole pattern
 - in 2 mm increments
- On the horizontal SE enclosure section, in the width, top

Material:

- Die-cast zinc

Supply includes:

- 1 set =
 - 1 support bracket
 - 1 stay
 - 3 sheet metal screws 5.5 x 13 mm

Packs of	Model No.
6 set(s)	8800.330



Also required:

- U nuts (recommended: M6), see page 538
- Multi-tooth screws M6 x 12 mm, see page 539

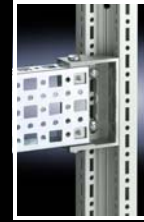

Support Bracket PS

For attaching:

- Punched section without mounting flange 23 x 73 mm, or
- Punched rails 23 x 23 mm

Installation options:

- On the vertical TS enclosure section using
 - Snap-on nut 8800.806, see page 533 or
 - Adapter rail for PS compatibility, see page 526
- On the horizontal TS enclosure section
- On the horizontal SE enclosure section, bottom
- On the horizontal SE enclosure section, top in the depth
- On enclosures and rails with rectangular hole profile 12.5 x 10.5 mm

Material:

- Die-cast zinc

Supply includes:

- 1 set =
 - 1 support bracket
 - 2 countersunk screws
 - 2 serrated washers

Packs of	Model No.
24 set(s)	4183.000



Also required:

- U nuts (recommended: M6), see page 538
- Multi-tooth screws M6 x 12 mm, see page 539
- Adapter rail for PS compatibility (for mounting on vertical enclosure section), see page 526



Interior Fittings

Assembly Components

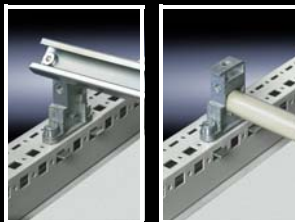
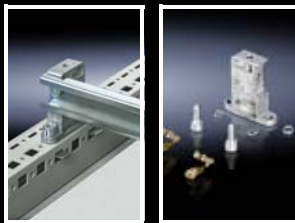

Bracket/Spacer

For the attachment of C rails, support profiles or cable clamping rails (angle profile). On the sides, to accommodate square sections or tubes (\varnothing 20 mm). Fastening points with M8 thread.

Installation options:

- On the vertical TS, SE enclosure section using
 - Snap-on nut 8800.808, see page 533 or
 - Adapter rail for PS compatibility, see page 526
- On the horizontal TS enclosure section
- On the horizontal SE enclosure section, bottom
- On the horizontal SE enclosure section, top in the depth
- On enclosures and rails with rectangular hole profile 12.5 x 10.5 mm

Packs of	Model No.
6 set(s)	4199.000

Material:

- Die-cast zinc

Supply includes:

- 1 set =
 - 1 bracket / spacer
 - 2 screws M8 x 16 mm
 - 2 spring lock washers
 - 2 captive nuts M8
 - 2 serrated washers
 - 2 sheet metal screws



Accessories:

- Angle piece 4134.000, see page 536

Quick-Assembly Block

For a variety of configuration options.

Installation options:

- On the vertical TS, SE enclosure section using
 - Snap-on nut 8800.808, see page 533 or
 - Adapter rail for PS compatibility, see page 526
- On the horizontal TS enclosure section
- On the horizontal SE enclosure section, bottom
- On the horizontal SE enclosure section, top in the depth
- On enclosures and rails with rectangular hole profile 12.5 x 10.5 mm

Packs of	Model No.
12 pc(s).	4133.000

Material:

- Die-cast zinc

Supply includes:

- 12 quick-assembly blocks
- 12 speed nuts M8
- 24 screws M8 x 12 mm
- 24 square nuts M8

Angle Piece

For the configuration of punched rails and mounting surfaces with a 45° slope.

Installation options:

- On the vertical TS, SE enclosure section using
 - Snap-on nut 8800.806, see page 533 or
 - Adapter rail for PS compatibility, see page 526
- On the horizontal TS enclosure section
- On the horizontal SE enclosure section, bottom
- On the horizontal SE enclosure section, top in the depth
- On enclosures and rails with rectangular hole profile 12.5 x 10.5 mm

Packs of	Model No.
12 set(s)	4134.000

Material:

- Angle pieces: Die-cast zinc
- Insulating pieces: Plastic

Supply includes:

- 1 set =
 - 1 angle piece
 - 1 insulating piece
 - 1 insulating screw
 - 2 assembly screws
 - 1 speed nut M6

Interior Fittings

Assembly Components

Universal Bracket

For the installation of

- Enclosure lights in
 - AE compact enclosures
- Door-operated switches in
 - AE compact enclosures
 - TP TopConsole system
- Cable conduit holders 2593.000 and 2591.000 in
 - AE compact enclosures
- Support rails for terminals in
 - Command panels and command panel housings

Assembly screws are concealed when the door is closed. Existing holes for mounting blocks or hinges may be used with AE.

Material:

- Carbon steel, zinc-plated

Supply includes:

- Assembly components

Packs of	Model No.
6 pc(s).	2373.000

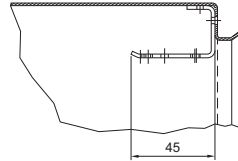
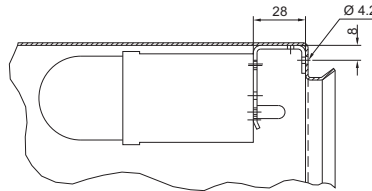

Rail Mounting Bracket

for individual rail mounting.

Material:

- Carbon steel, zinc-plated

Rail Mounting Bracket	Packs of	Model No.
Flat	20 pc(s).	2365.000
Inclined	20 pc(s).	2366.000

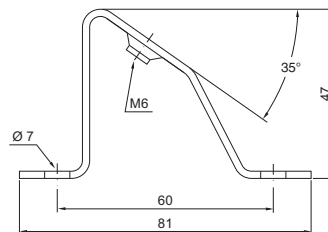
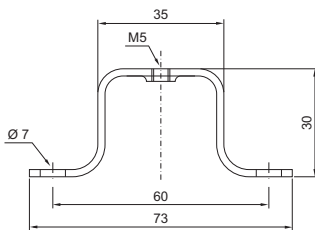

Mounting Block

for AE

As an accessory for additional interior fittings, e.g. to fit cable ties, PS punched rails, top hat rails and C rails (e.g. for a second mounting level).

Supply includes:

- Assembly components

Packs of	Model No.
20 pc(s).	2574.000



Interior Fittings

Assembly Components



U Nuts

for

- Punched rail 23 x 23 mm
- Punched section without mounting flange 23 x 73 mm
- Punched section without mounting flange 45 x 88 mm
- System chassis 23 x 73 mm

For mounting punched rails and punched sections without mounting flange on angle brackets, mounting brackets and support brackets, we recommend U nuts with M6 thread, 4179.000.

Thread	Packs of	Model No.
M4	20 pc(s).	4119.000
M5	20 pc(s).	4157.000
M6	20 pc(s).	4179.000
M8	20 pc(s).	4180.000

+ Accessories:

- Multi-tooth screws M6 x 12 mm, for 4179.000, see page 539

Captive Nuts/Threaded Blocks

Installation options:

On enclosures and rails with rectangular hole profile 12.5 x 10.5 mm as for example on

- TS, SE enclosure section
 - Vertical, via adapter rail for PS compatibility
 - TS horizontal, direct
- SE horizontal bottom, direct
- SE horizontal top (in the depth only), direct
- Punched rails 23 x 23 mm
- Punched section without mounting flange 23 x 73 mm
- Punched section without mounting flange 45 x 88 mm
- System chassis 23 x 73 mm

⇌ Possible alternative:

- On the vertical TS enclosure section TS snap-on nut, see page 533



Captive nut

The compression spring designed as an insertion aid ensures reliable mechanical and electrical connection in the hole profile.

Thread	Packs of	Model No.
M5	50 pc(s).	4166.000
M6	50 pc(s).	4164.000
M8	50 pc(s).	4165.000



Threaded blocks

With snap-off insertion aid, made from die-cast zinc.

Thread	Packs of	Model No.
M6	50 pc(s).	4162.000
M8	50 pc(s).	4163.000



Captive nut

The nuts are inserted from the same side as screw-fastening takes place. This allows fastening points at the same height and width across corners.

The spring retainer also provides for electrical connection in the system punchings.

Thread	Packs of	Model No.
M6	50 pc(s).	8800.340
M8	50 pc(s).	8800.350

Spring Nut M5

For Comfort Panel from an installation depth of 74 mm. The spring ensures reliable protection from unintentional displacement.

Further interior fitting, e.g. with

- Mounting bracket 4597.000 (see page 531) or
- Mounting bracket for interior fitting 6205.100 (see page 532)

Material:

- Steel, zinc-plated

Packs of	Model No.
50 pc(s).	6108.000



Threaded Inserts M6

for KS

To secure installed equipment to the molded bosses in the door and in the rear housing panel.
Screw length available for insertion: 8 mm.

Packs of	Model No.
20 pc(s).	1482.000



Multi-tooth screws

M6 x 12 suitable for:

- Snap-on nuts (8800.806)
- U nuts (4179.000)
- Captive nuts (4164.000)
- Threaded blocks (4162.000)

M8 x 12 suitable for:

- Snap-on nuts (8800.808)

Multi-tooth drive for optimum transmission of torques, extended tool life and increased safety and reliability when tightening and loosening screw connections.

Type of screw	Dimensions mm	Packs of	Model No.
Multi-tooth screws	M6 x 12	300 pc(s).	2504.500
	M8 x 12	300 pc(s).	2504.800
Multi-tooth sheet metal screws	5.5 x 13	300 pc(s).	2486.500
Multi-tooth sheet metal screws for stainless steel	5 x 13	300 pc(s).	2486.300
Self-tapping screws:			
■ Hex screws	M5 x 10	500 pc(s).	2504.000
	M5 x 12	500 pc(s).	2488.000
■ Posidrive raised countersunk screws	M5 x 12	500 pc(s).	2489.000
■ Pan-head screws, posidrive	M5 x 12	500 pc(s).	2489.500
■ Pan-head screws, multi-tooth	M5 x 12	500 pc(s).	2489.500
Self-tapping screws	ST 4.8 x 16	300 pc(s).	2487.000



Multi-tooth sheet metal screws

For Ø 4.5 mm round holes in the enclosure profile, punched rails and punched section without mounting flange.



Self-tapping screws

For Ø 4.5 mm round holes in the enclosure profile, punched rails and punched section without mounting flange.



Self-tapping screws

Mark, drill and tighten in a single operation using electric or pneumatic tools.

For plate thickness: 0.8 – 3 mm

Length: 16 mm

Useful length: 9.5 mm

Width across flats: 8 mm

